

**Inami**

TRIAL FRAMES

# MANUAL

L-0391 | L-0391-G

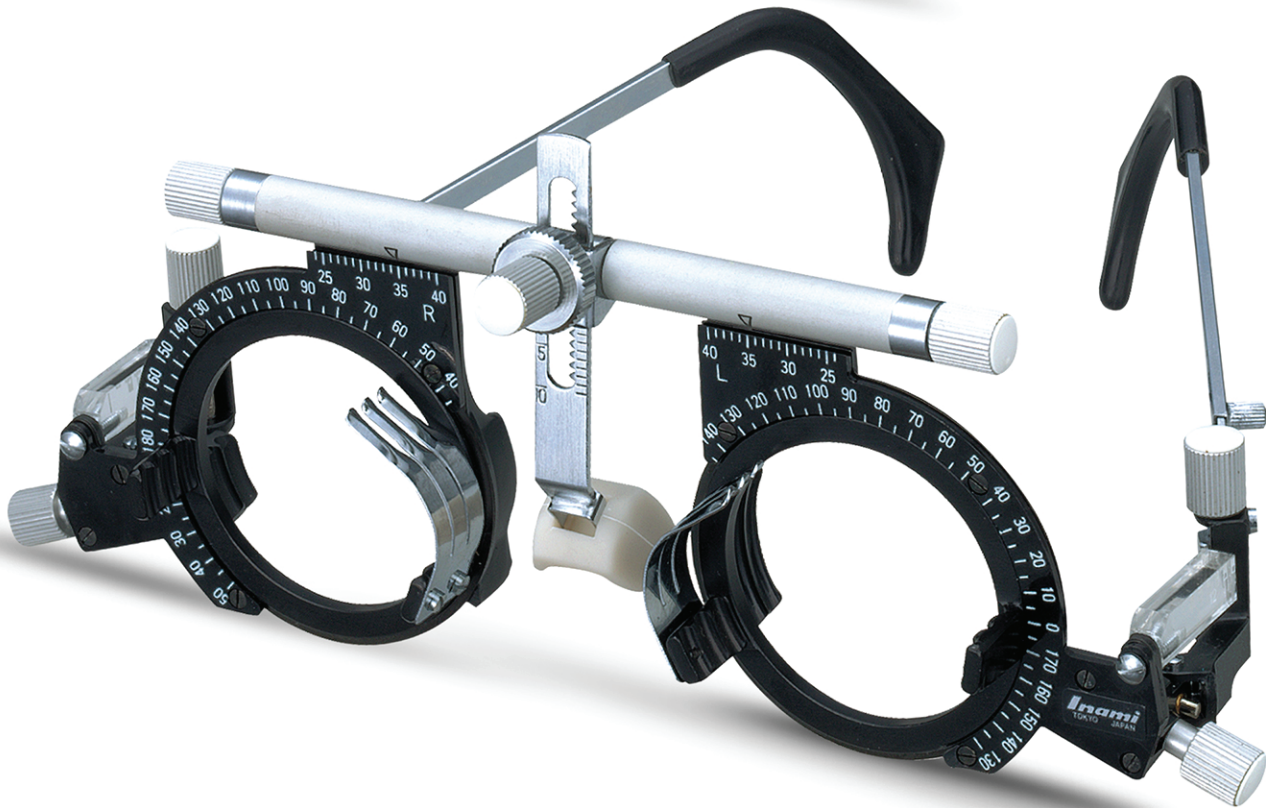
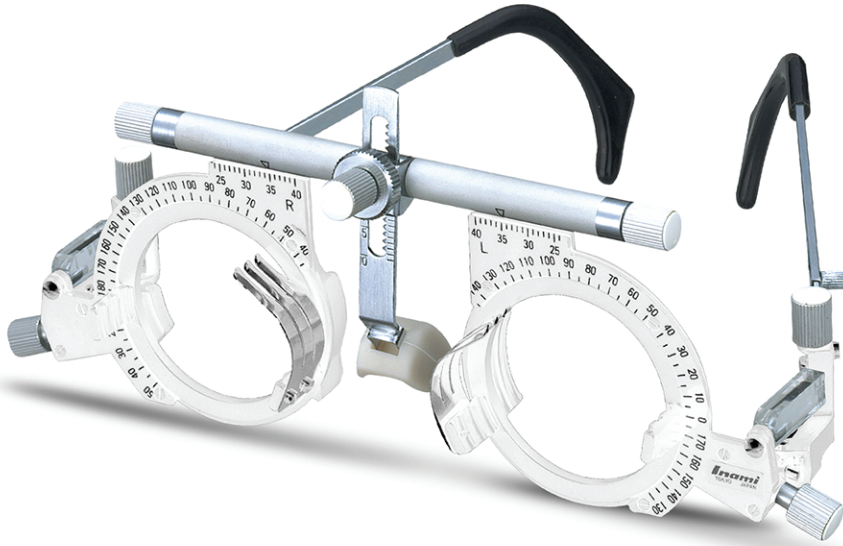

**VIEWLIGHT**  
POWERED BY INNOVATION

Before use this instrument, be sure to read this manual

EN

# UNIVERSAL LIGHTWEIGHT TRIAL FRAME K-0391

## NOMENCLATURE

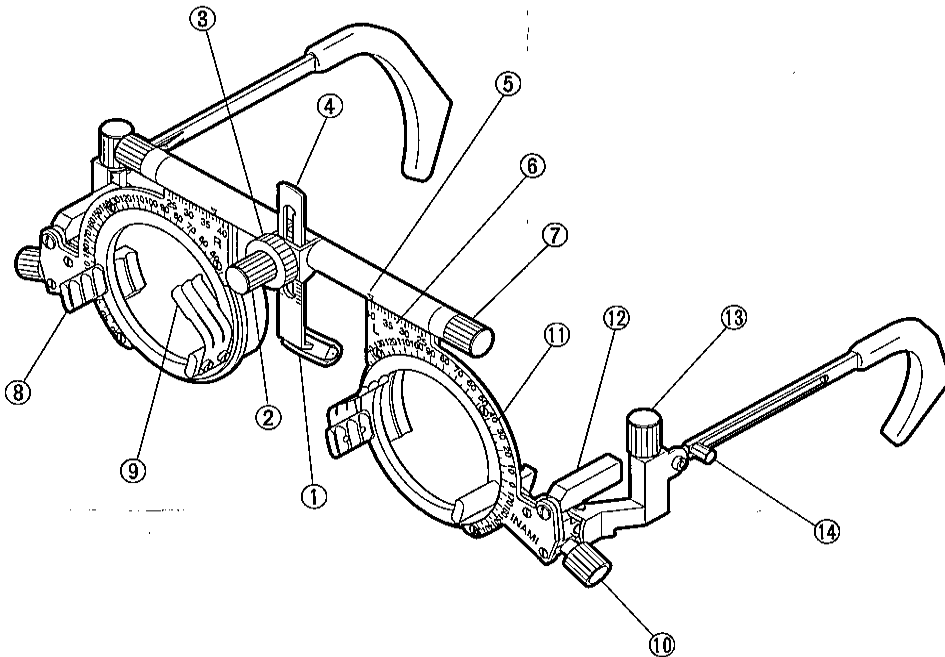

- |                                   |  |
|-----------------------------------|--|
| ① Nose pad                        | ⑧ Lens Holder                                |
| ② Nose pad adjustment knob        | ⑨ Lens fixation plate                        |
| ③ Nose pad position fixation knob | ⑩ Lens rotation knob                         |
| ④ Nose pad adjustment plate       | ⑪ The Measure for the axis of the lens       |
| ⑤ The Index for PD Measuring      | ⑫ The Measure for the position of the Cornea |
| ⑥ The Measure for PD              | ⑬ Frame up-down adjustment knob              |
| ⑦ PD adjustment knob              | ⑭ Frame length adjustment knob               |

## SPECIFICATIONS & ACCURACY

- |                                 |   |
|---------------------------------|---|
| 1) PD distance :                | 48-80mm ( $\pm 0.8$ mm)   |
| 2) Cornea measuring plate :     | 2mm interval  |
| 3) Frame adjustable angles :    | 35° (upward $30^{\circ \pm 5^{\circ}}$ , downward $5^{\circ - 2^{\circ}}$ ) |
| 4) Frame adjustable length :    | 35mm  |
| 5) Nose pad adjustable angles : | 360°  |
| 6) Nose pad adjustable length : | 22mm $\pm 1.5$ mm   |
| 7) Maximum available lenses :   | 10 pcs.   |
| 8) Axis of lens :               | $0^{\circ \pm 5^{\circ}}$ , $180^{\circ \pm 5^{\circ}}$                     |

# Universal Lightweight Trial Frame K-0391

---

## FEATURES

1. This is designed to make a precise subjective measurement with the Test chart, and now it was improved easier to insert the lens and measure the patient eye.
2. It permits to adjust the PD, axis of the lens, length of the frame, position of the nose pad, so you will make a smooth precise measurement.
3. As a maximum 5 pcs. of the lenses will be inserted, so it will permit the smooth and precise reading of the Test chart.

## IN STORAGE

Never store the unit in a place where it is splashed with water and where gas, liquid, salty or sulfurous circumstances which give adverse affect to the frame.

Store the unit in a place where it is not exposed to direct sunlight and in the specified temperature and humidity. Also avoid a lot of dust. This kind of environment gives and adverse effect to the inside parts of the system.

## BEFORE OPERATION

Before wear it for patient, kindly pre-check to avoid any problem during in operation.

- 1) Check the movement of PD adjustment knob (⑦).
- 2) Check the fixation, i.e. weakness, hardness of lens fixation plate (⑨).
- 3) Check the movement of lens rotation knob (⑩).
- 4) Check the movement of nose pad position fixation knob (③).
- 5) Check the movement of frame up-down adjustment knob (⑬).
- 6) Check the movement of frame length adjustment knob (⑭).
- 7) Check the bent of the frame bridge (Open & Close).

## PREPARATION OF OPERATION

Before starting to insert the lens, please make sure the correctly fitting for patient eye, such as PD and length of the bridge etc. If incorrect, the measuring result will be changed.

## AFTER USE

After use it, keep clean and wipe with soft cloth.



***Inami & Co., Ltd.***

No.24-2, Hongo 3-chome,  
Bunkyo-ku, Tokyo 113-0033, Japan  
TEL.81-3-3814-5916 FAX.81-3-5684-2126