

# VIEWLIGHT

POWERED BY INNOVATION



**NEW**  
AUTO REFRACTOR & KERATOMETER  
**URK-800A**



Sold ONLY in Latan Market



## PRODUCT URK-800A

The *Smart* autorefractor keratometer URK-800A is the new generation of ophthalmic equipment featuring an illumination sensor, focusing navigator, multilevel dial types, extremely rapid automatic measurements and highly accurate data.

## EASY CONNECTION



## WITH OTHER DEVICES

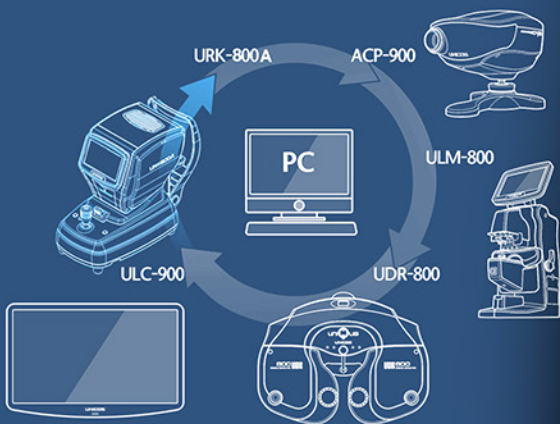

## DIOPTRIC MEASUREMENTS



URK-800A covers a wide measurement range, from -25D to +22D, even an examiner with strong myopia can be measured.

## DISTANCE CONTROL

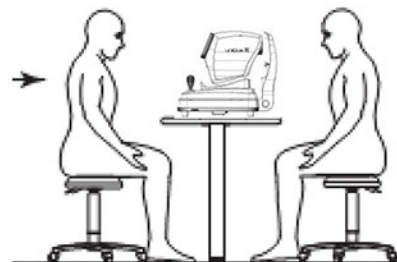

Safe patient environment  
(follow COVID-19 regulations)  
wear a face mask while operating  
and in direct contact between  
the patient or the operator  
and third person.

## ILLUMINATION SYSTEM

Features a well developed illumination system able to observe eye condition of the cataract or contact lens surface. It is able to save 2 images of each eye and continuous observation.

# URK-800A

AUTO REFRACTOR  
& KERATOMETER

## Convenient User MENU SETTING

The operator may alter set-up easily and faster by an unique design.

It may measure periphery of cornea both horizontally and vertically from the center of cornea to get curvature and eccentricity value of all points. It may allow the best fitting for contact lenses.

Vertex Distance  
PD Measurements  
Intraocular Lens Mode  
Measumemet Value

44.76D

44.64D

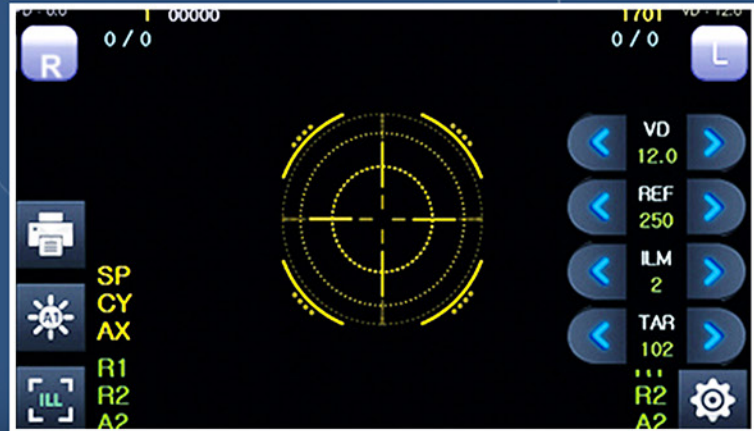

Retino illumination

## Built-in TECHNOLOGY

Measured  
RESULTS

Recognizing of measurement  
MODE, DATE, AVERAGE VALUE



## PRINTER

Quick and Automatic

The printing paper with data is cut automatically with high speed.



## OTHER FEATURES

URK-800A measure the periphery of cornea both horizontally and vertically from the center of cornea to get curvature and eccentricity value of all points. It may allow the best fitting for contact lenses.

## LANGUAGES

Supports up to 10 languages:

Chinese, English, German Italian, Japanese, Russian  
Portuguese, Spanish Korean, and French

ECC

KER

Diop

Color

## PRODUCT OVERVIEW



1. Head Rest
2. Measurement Window
3. Height Lining mark
4. Adjustable Chin Rest
5. 8" Touch Screen Monitor
6. Thermal Printer
7. Measurement Button
8. Joystick
9. Stage Holding Knob
10. Chin Rest Up/Down Button
11. Print Button
12. Power Switch

## ACCESSORIES (Included)

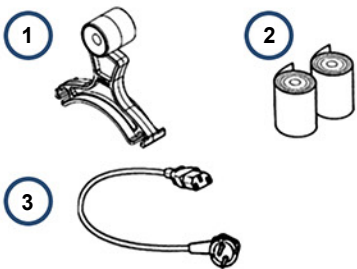

1. Model Eye
2. Printing Paper
3. Power Supply Cable

# URK-800A

AUTO REFRACTOR  
& KERATOMETER

## ACCURATE DATA

*URK-800A is designed with an image chip, to allow REF measuring speed to be faster to get a more accurate and stable measurement data.*



### PRODUCT SPECIFICATIONS:

| Refractometry                    |   |                      |
|----------------------------------|---|----------------------|
| Vertex Distance(VD)              | 0.0 , 10.0, 12.0, 13.5, 15.0mm  |                      |
| Sphere(SPH)                      | -25.00 ~ +22D (VD 12mm)   | Unit : 0.12 / 0.25 D |
| Cylinder(CYL)                    | 0.00 ~ ±10.00D  | Unit : 0.12 / 0.25 D |
| Axis(AX)                         | 1 ~ 180°  | Unit : 1°            |
| Cylinder form                    | -, +, MIX   |                      |
| Pupil Distance(PD)               | 10 ~ 85mm   |                      |
| Minimum Pupil Diameter           | Ø2.0mm  |                      |
| Keratometry                      |   |                      |
| Radius of Curvature              | 5.0 ~ 10.2mm  | Unit : 0.01mm        |
| Corneal Power                    | 33.00 ~ 67.50D  | Unit : 0.12/ 0.25 D  |
| Corneal Astigmatism              | 0.00 ~ -15.00D  | Unit : 0.12/ 0.25 D  |
| Axis                             | 1 ~ 180°  | Unit : 1°            |
| Corneal Diameter                 |   |                      |
| Corneal Diameter                 | 2.0 ~ 12.00mm   | Unit : 0.1mm         |
| ETC.                             |   |                      |
| Storage Memory                   | 10 measurement each eyes  |                      |
| Internal Printer                 | Thermal printer   |                      |
| Display                          | 7.0 inch TFT COLOR LCD Monitor, Touch   |                      |
| Chin rest movement               | Max 65mm, electrical movement   |                      |
| Operation environment            | Temperature : +10℃ ~ +40℃<br>Humidity : 30% ~ 80% RH<br>Atmospheric pressure range : 70 kPa ~ 106 kPa<br>Shock (without packaging) : 10g / 6ms  |                      |
| Storage and Movement environment | Temperature : +10℃ ~ +55℃<br>Humidity : 10% ~ 90% RH<br>Atmospheric pressure range : 50 kPa ~ 106 kPa<br>Shock : 30g / 6ms<br>Permanent shock : 10g / 6ms<br>Oscillate(sine curve) : 10Hz ~ 500Hz, 0.5g |                      |
| Power supply                     | AC100V ~ 240V, 50/60Hz  |                      |
| Power consumption                | 60 - 90VA   |                      |
| Dimension                        | 275mm(W) x 525mm(D) x 450mm(H)  |                      |
| Weight                           | 18kg  |                      |

